

MACHINING OF GUIDE VANE

Indent No: 20220023

i) PRE QUALIFICATION REQUIREMENT

S.No.	BHEL Requirements	Vendor's Confirmation
1	Vendor should have a LATHE machine having "Swing over bed (SOB)" Dia 1100mm or more and that can accommodate a job of length 2.5 metres or more	Vendor to Confirm and submit detail
2	Vendor should have material handling capacity \geq 2.0MT	Vendor to Confirm and submit detail

ii) TECHNICAL REQUIREMENT

S.No.	BHEL Requirement	Vendor's Confirmation
1	Machining as per drawing no. 1-203-01-20502/M:Rev-B	Vendor to confirm
2	Vendor to arrange all tools & instruments required for machining of the job	Vendor to confirm
3	BHEL reserves the right to visit vendor for stage inspection during job machining to assess the progress and technical aspects and further processing shall be done accordingly.	Vendor to confirm
4	Final Inspection of the machined job may be carried out by BHEL at vendor's works before despatch	Vendor to confirm
5	Delivery requirement: 2 weeks/pc from the date of lifting	Vendor to confirm
6	Identification details on the casting to be maintained	Vendor to confirm
7	Vendor to submit following with the offer:- a) Details of the Organization b) Details of the machine tools and other facilities installed in the company	Vendor to submit
8	Vendor to submit Filled Supplier Registration Form along with Requisite Documents to SDC Cell in MM Deptt. of CFFP, BHEL, Haridwar. If already registered at CFFP or any other unit of BHEL, then Vendor code may be furnished.	Vendor to submit
9	Vendor may plan a visit to CFFP for technical discussion.	Vendor to Note
10	BHEL team may visit vendor's works for facility/capacity verification.	Vendor to Accept

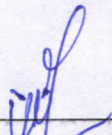
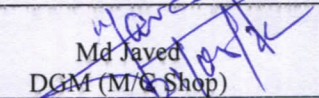
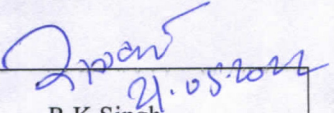
 Vikalp Bibhuti Dy. Manager (M/C Shop)	 Md Javed DGM (M/C Shop)	 R.K.Singh AGM (M/C Shop) 21.05.2022
---	--	--

FIRST ANGLE PROJECTION (ALL DIMENSIONS ARE IN ')

DRAWING NUMBER
1-203-01-20502/M

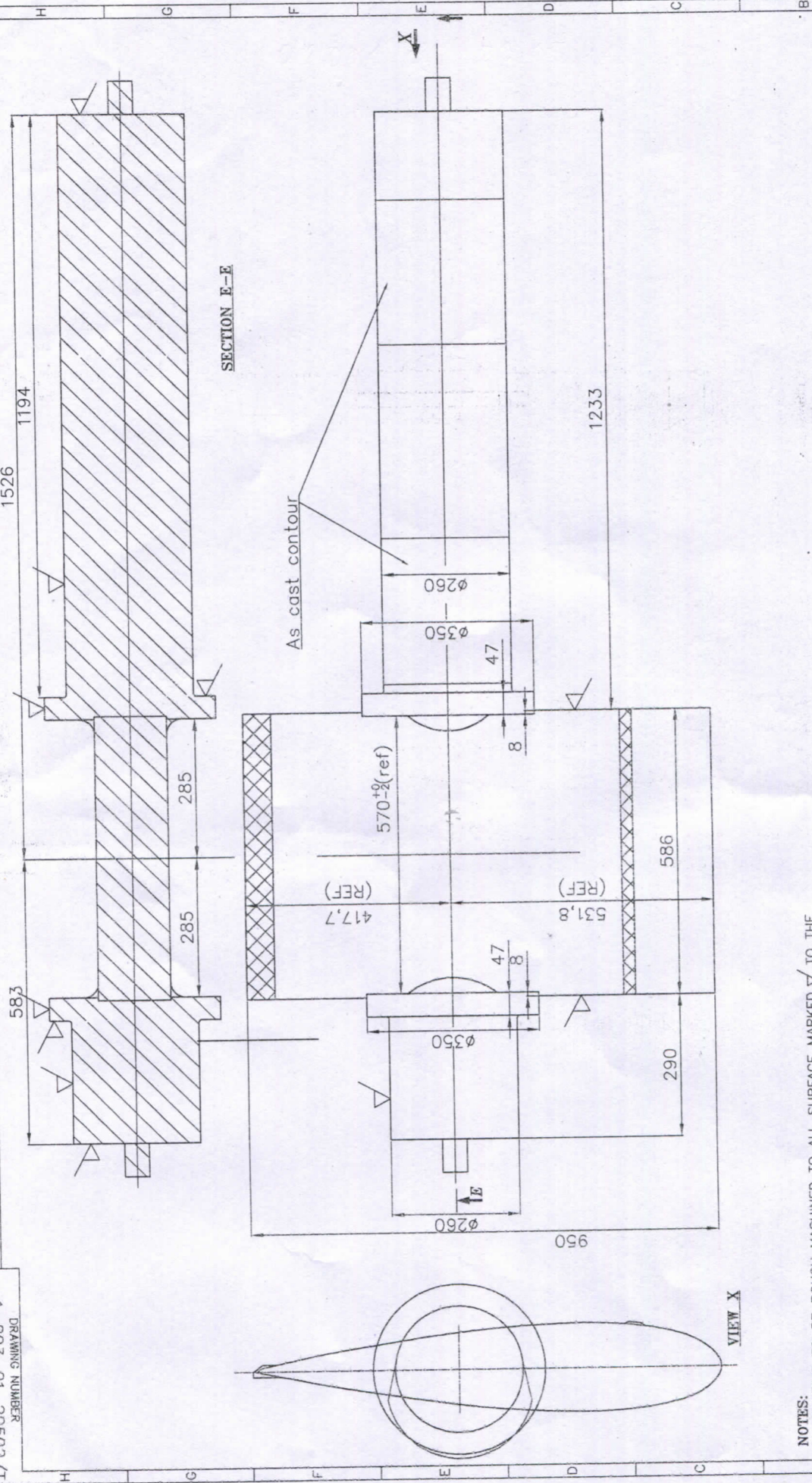

		DEPT. FDY. TECH.	SCALE N.T.S.	WEIGHT IN KGS	SIGN.	DATE
BHARAT HEAVY ELECTRICALS, LTD. CENTRAL FOUNDRY FORGE PLANT		DRN 23/ARUN/JL/23827M	WKO L. AGGARWAL -SD- 15.10.19	CHD R. LAKRA -SD- 16.10.19	APPD R. LAKRA -SD- 16.10.19	PROJECT AND CUSTOMER NAME ARUN JI BHOPAL
TITLE ROUGH M/C DRG FOR GUIDE VANE		TECHNOLOGY NO 23587		DRAWING NO 1-203-01-20502/M		SHEET NO. - 1 NO. OF SHEETS - 1

- NOTES:
- CASTING TO BE ROUGH MACHINED TO ALL SURFACE MARKED ✓ TO THE DRG. DIMENSIONS OF A SURFACE FINISH OF 12.5 MICRONS, WITHIN A TOLERANCE OF ON +2MM, UNLESS OTHERWISE SPECIFIED.
 - THIS DRG. IS ISSUED FOR THE PURPOSE OF ROUGH MACHINING ONLY. FOR ALL OTHER DETAILS PLEASE REFER COMPONENT DRG. NO. 1-203-01-20502 REV 00
 - CASTING IS TO BE MACHINED BASED ON CENTER LINES PROVIDED BY MARKING GROUP AT FOUNDRY USING THE PROFILE TEMPLATE
 - WT. OF CASTING BEFORE M/C: 1645 KGS
WT. OF CASTING AFTER M/C: 1401 KGS
 - MATERIAL GRADE: ASTM A743 CA6NM (13Cr-4Ni SS)

22004